

### Detalle apoyo Gabinete

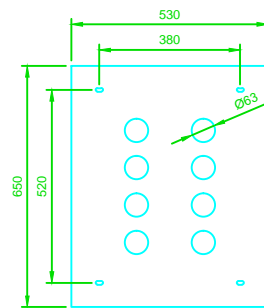

### Elevación Principal emplazamiento Corte A-A

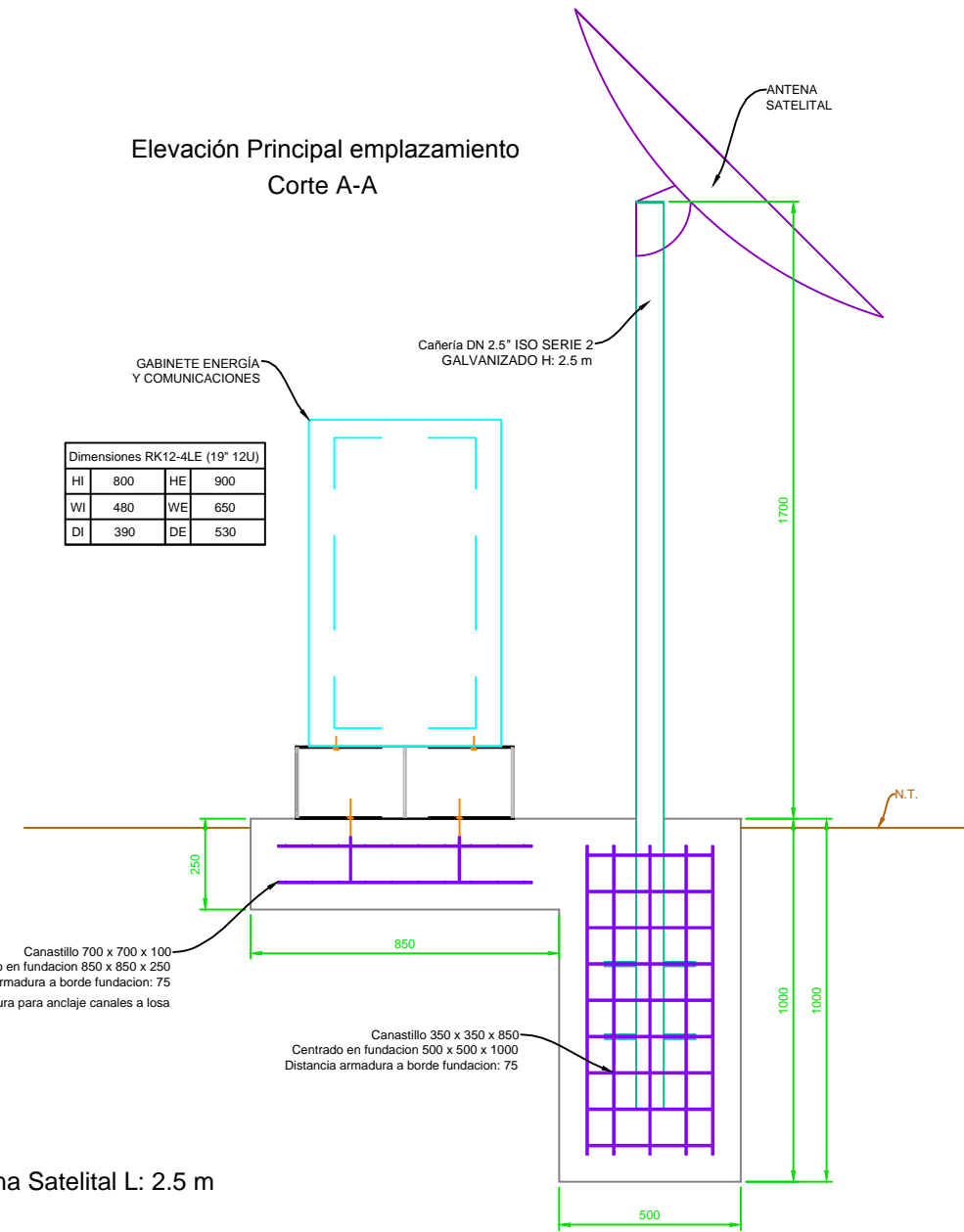

Dimensiones RK12-4LE (19' 12U)			
HI	800	HE	900
WI	480	WE	650
DI	390	DE	530

### Detalle Perfil Canal L: 0.6 m

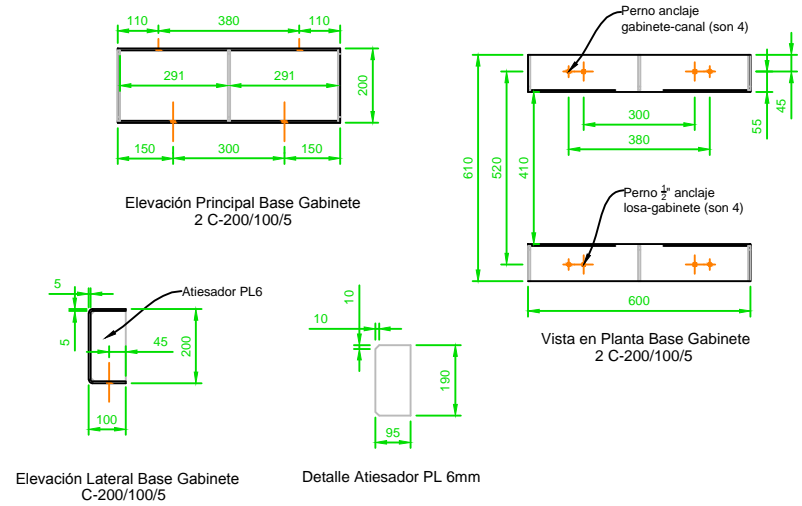

### Detalle Poste Antena Satelital L: 2.5 m

